

## Xerox Model 3340/3345 Magnetic Tape System

The Xerox Model 3340/3345 Magnetic Tape System, designed for use as an input/output device for Xerox computers, reads and writes data in a nine-channel, industry-compatible recording format in densities of 800 and 1600 bits per inch. The system consists of one Model 3340 controller and from one to eight Model 3345 transports. The Model 3340 also serves as the controller for Xerox Model 3347 transports. Model 3345 transports may be intermixed with Xerox Model 3347 transports

in any combination to a maximum of eight transports per Model 3340 controller. Optionally available with the Model 3340 is a Dual Access feature.

The system operates at 75 inches per second with transfer rates of 60,000 and 120,000 8-bit bytes per second. Vacuum column buffering provides for gentle tape handling, and the transports feature a single capstan drive. A power window is provided for ease of operation.

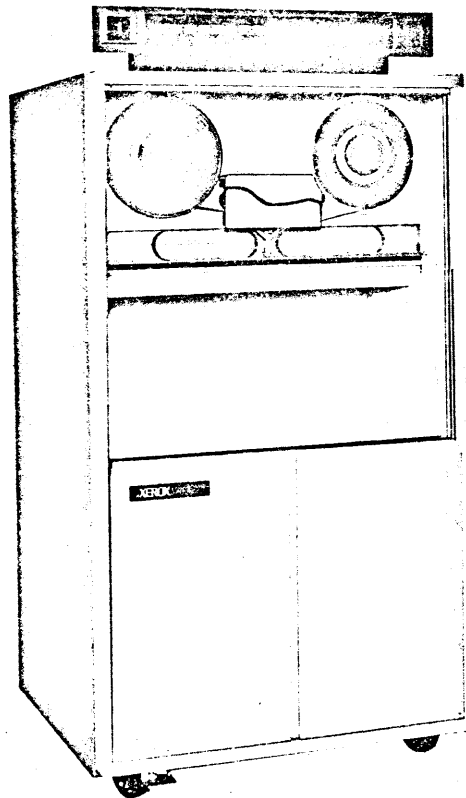

# Xerox Model 3340/3345 Magnetic Tape System

## Specifications

### Operating Characteristics

Tape Speed	75 in./sec.
Start/Stop Time	4.3 msec.
Rewind Time (2400 ft.)	120 sec.
Recording Methods	NRZI and PE
Recording Densities	800 and 1600 bpi
Recording Formats	9-channel, industry-compatible (USA Standard X3.2.1/385 for NRZI, USA Standard X3.2.1/400 for PE)

### Data Transfer Rates

60,000 and 120,000 bytes/sec.

### Tape Tape Reels

1/2 in., 1.5 mil Mylar  
Standard 5 in. to 10.5 in. reels

### Physical Dimensions (approx.)

#### Model 3345 Tape Units

Height	66 in.
Width	33 in.
Depth	30 in.
Weight	600 lbs.

#### Model 3340 Controller

Space is provided within the host mainframe.

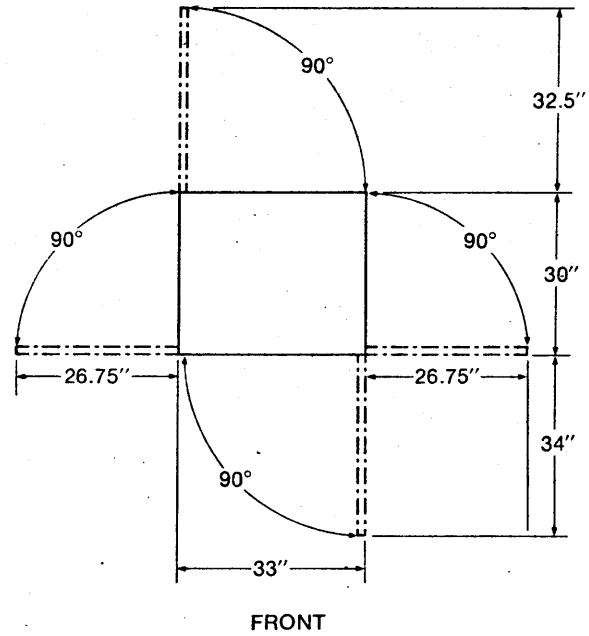

NOTE: All dimensions are approximate.